

STORMWATER PLAN



- C = 0.35 (3.60Ha)
- C = 0.70 (12.99Ha)
- C = 0.90 (1.09Ha)
- C = 0.75 (6.568Ha)

Note: All dimensions and areas shown on this plan are subject to Council approval and survey

DATE	DESCRIPTION / VERSION	REVISION STATUS
07-02-24	For Approval	5
15-12-23	For Approval	4
26-05-23	For Approval	3
12-10-22	For Approval	2
5-4-22	For Approval	1

NORTH EAST

SURVEY DESIGN

ABN 83 127 459 367
 PO Box 882
 Wangaratta VIC 3676
 Mobile 0407 216 710
 Fax 03 5721 6701
 matt@nesd.com.au
 www.nesd.com.au

For: **BISLAKE PTY LTD**
 At: **CLARKES LANE WANGARATTA**
SWMP DEVELOPMENT PLAN

Project No: **M6801** Version: **5**
 Drawn By: **MS** Checked/Signed By: **MB**

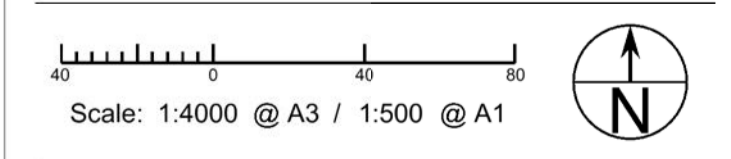

Status:
FOR APPROVAL

Print Date: \$DATES
 Drawing Name: \$MODELS
 File Name: \$FILES

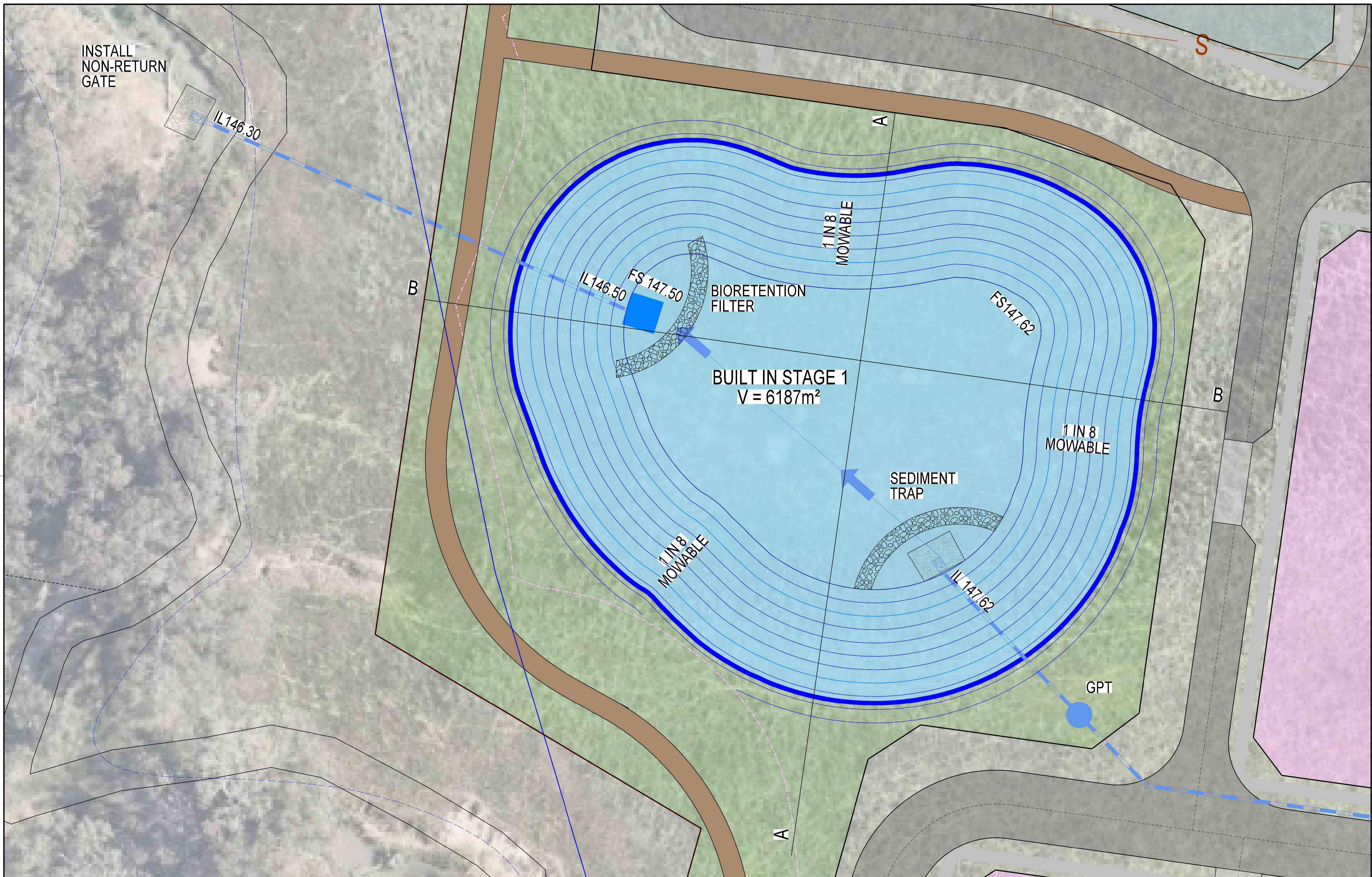

VERSION	DATE	AMENDMENT / VERSION DESCRIPTION
01	25 JANUARY 2023	ISSUED FOR AUTHORITY COMMENTS
02	05 FEBRUARY 2024	ISSUED FOR AUTHORITY APPROVAL

NOTES:

PRELIMINARY DRAWING
NOT TO BE USED FOR CONSTRUCTION PURPOSES

SCALE 1:200

SHEET SIZE A1

DATUM LEVELS ARE IN METRES TO AHD

LENGTHS ARE IN METRES



ABN 83 127 459 367
PO Box 882
Wangaratta VIC 3676
Mobile 0407 216 710
Fax 03 5721 6701
matt@nesd.com.au
www.nesd.com.au

PRELIMINARY BASIN DETAILS
CLARKES LANE WANGARATTA
- BISLAKE PTY LTD

ISSUE STATUS
FOR AUTHORITY APPROVAL

REFERENCE VERSION
M6801 | 02 | SHEET 1 OF 2

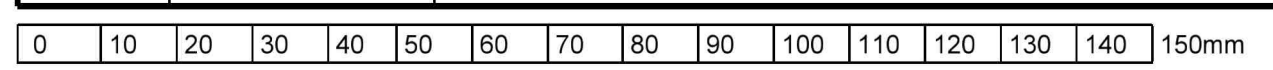

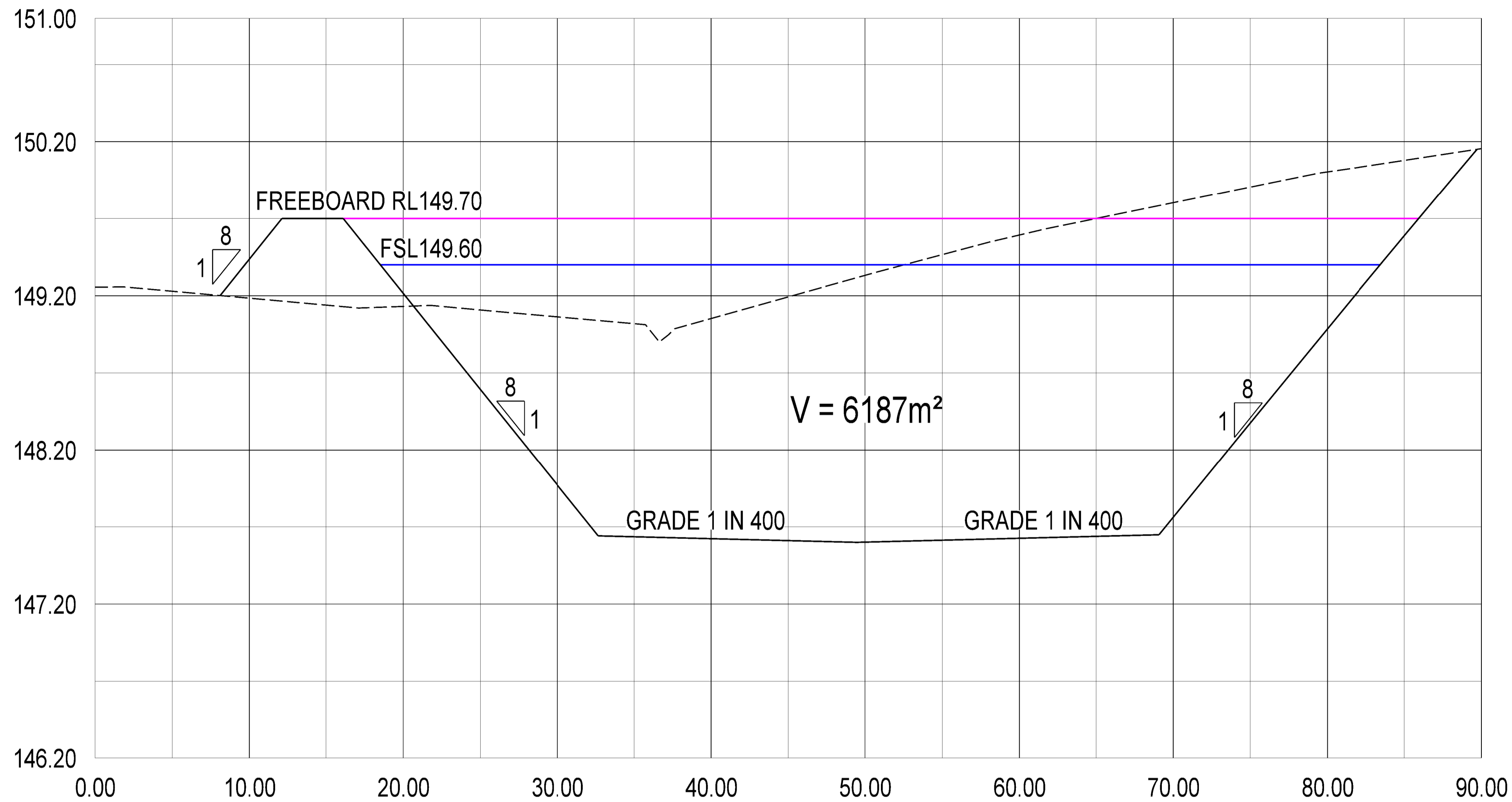

SECTION A - A

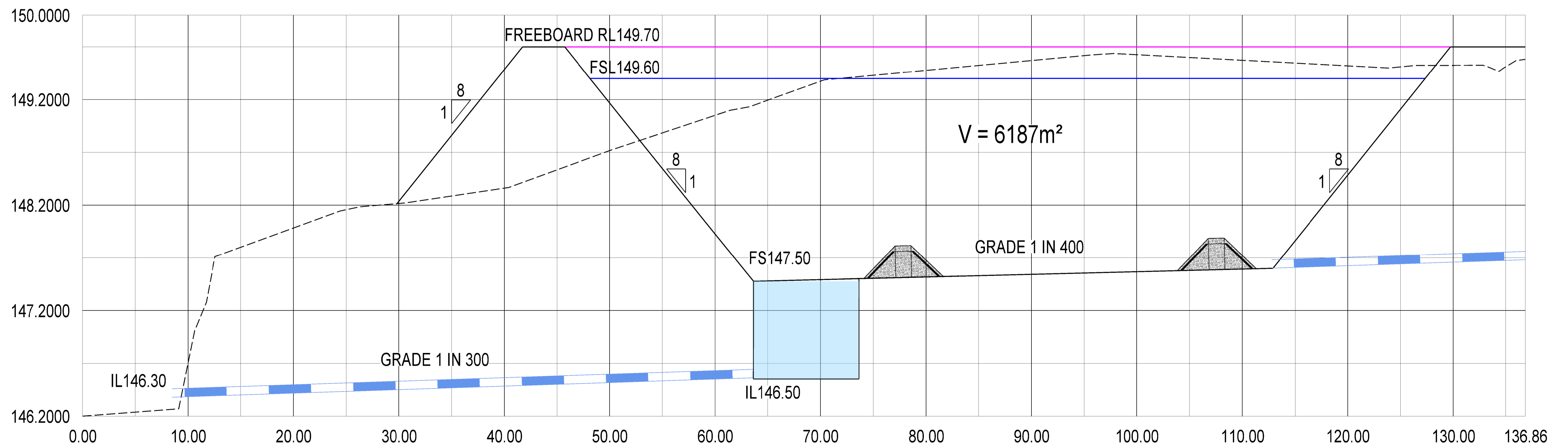
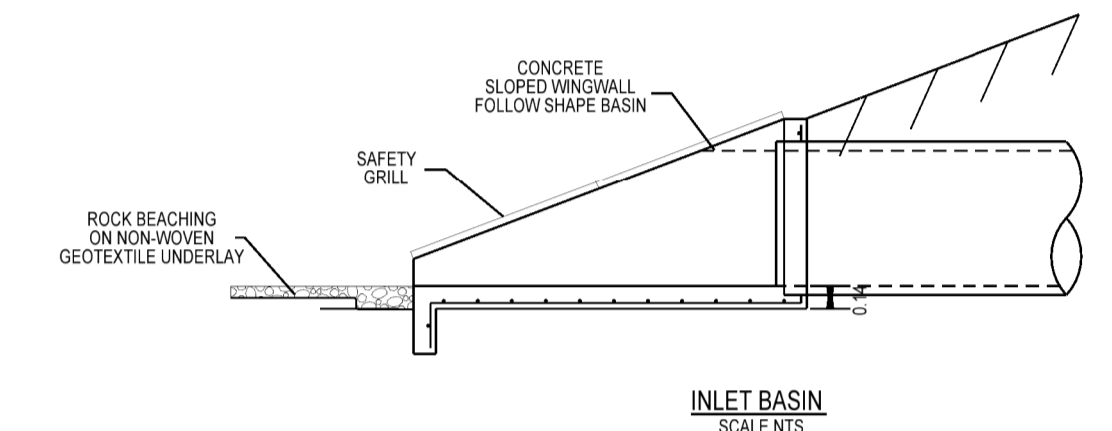
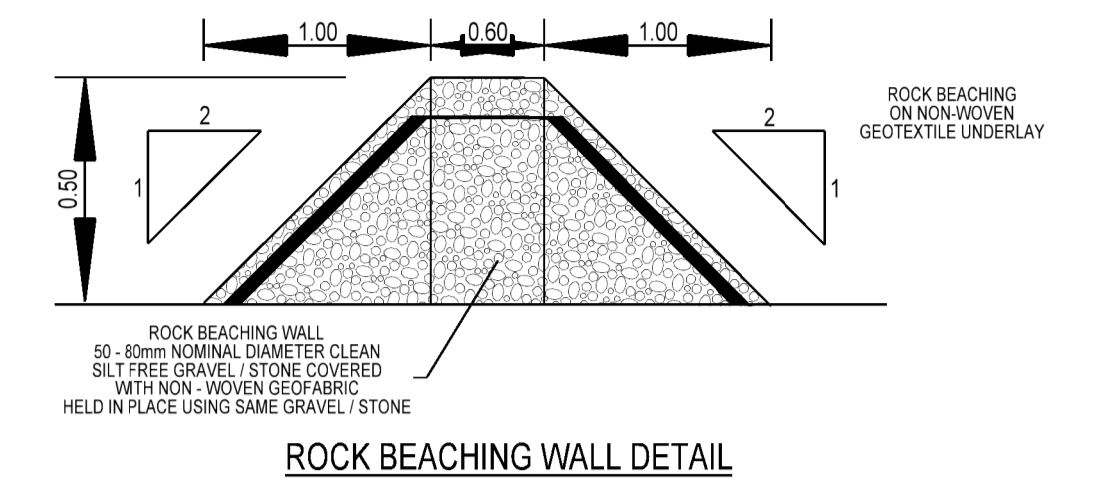

SECTION B - B

VERSION	DATE	AMENDMENT / VERSION DESCRIPTION
01	25 JANUARY 2023	ISSUED FOR AUTHORITY COMMENTS
02	05 FEBRUARY 2024	ISSUED FOR AUTHORITY APPROVAL

NOTES:

PRELIMINARY DRAWING
NOT TO BE USED FOR CONSTRUCTION PURPOSES

SCALE: H:1:200 V:1:20
SHEET SIZE: A1
LEVELS ARE IN METRES TO AHD
LENGTHS ARE IN METRES

NORTH EAST SURVEY DESIGN

ABN 83 127 459 367
PO Box 882
Wangaratta VIC 3676
Mobile 0407 216 710
Fax 03 5721 6701
matt@nesd.com.au
www.nesd.com.au

PRELIMINARY BASIN DETAILS
CLARKES LANE WANGARATTA
- BISLAKE PTY LTD

ISSUE STATUS: FOR AUTHORITY APPROVAL
REFERENCE: M6801_02 SHEET 2 OF 2

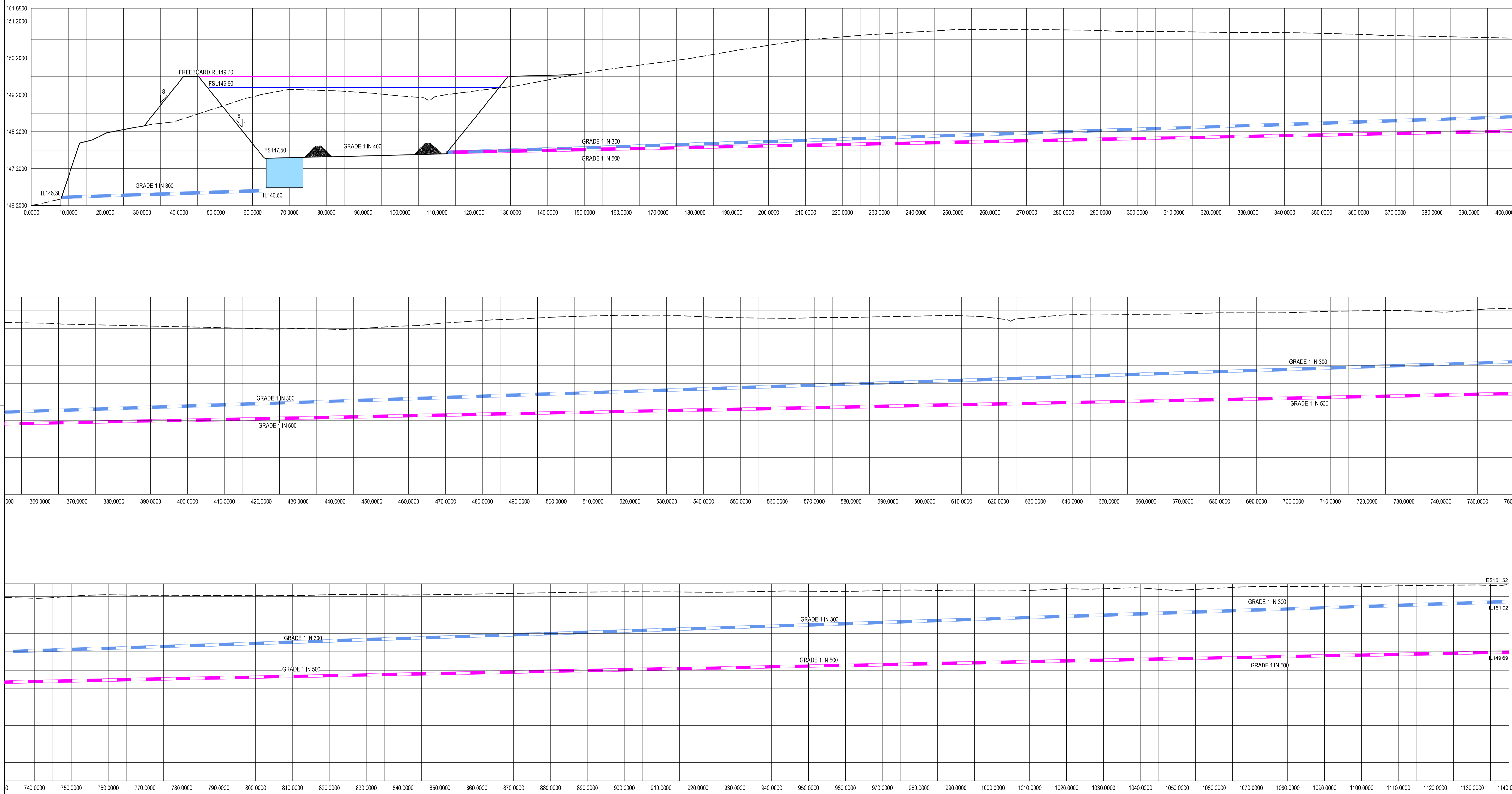

VERSION	DATE	AMENDMENT / VERSION DESCRIPTION
01	29 MAY 2023	ISSUED FOR AUTHORITY COMMENTS
02	05 FEB 2024	ISSUED FOR AUTHORITY COMMENTS

NOTES:

PRELIMINARY DRAWING
NOT TO BE USED FOR CONSTRUCTION PURPOSES

SCALE: 1:500

SHEET SIZE: DATUM A1

LENGTHS ARE IN METRES



ABN 83 127 459 367
 PO Box 882
 Wangaratta VIC 3676
 Mobile 0407 216 710
 Fax 03 5721 6701
 matt@nesd.com.au
 www.nesd.com.au

PRELIMINARY DRAINAGE LONG SECTION
CLARKES LANE WANGARATTA
- BISLAKE PTY LTD

ISSUE STATUS	FOR AUTHORITY COMMENT
REFERENCE VERSION	M6801 02 SHEET 1 OF 1